

21 OCT 2016

R.L.Cummings
3 Ivey Terrace
Liskeard
CORNWALL
PL14 3HH
01579342181

TOWN CLERK
LISKEARD TOWN COUNCIL
3-5 West Street
PL14 6BW

20 October 2016

Dear Steven,

M |

I am writing as you suggested to the Town Council asking their permission, for Mr Turner of plot N to exchange his plot for mine, sometime in the future, as I do not intend to give up just yet.

As one gets older circumstances can change very quickly, and I find that what I can do today I might not be able to do tomorrow.

Mr Turner is a very good friend, and gardener, and I would like for him to have the benefits of most of my gardening equipment that I have accumulated over the 54 yrs or so that I have had this plot. He has provisionally agreed to purchase my greenhouses and my garden shed. By making this provisional agreement it will save myself, wife or family the hassle of dealing with this in the future.

I have enjoyed many years on this garden and seen many changes, and it is a big part of my social life, and a commitment that gets me out of the house.

As there has been quite a few plot exchanges just recently I thought it would be an appropriate time to seek this permission.

Yours sincerely

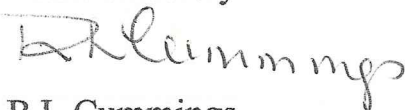

R.L.Cummings

RE: plot G2

From: adam hodgkins

Sent: Fri, 7 Oct, 2016 at 1:02 pm

To: Trudy Chatting

Hi Trudy

The greenhouse would be a 8' x 8'

Thanks

Adam

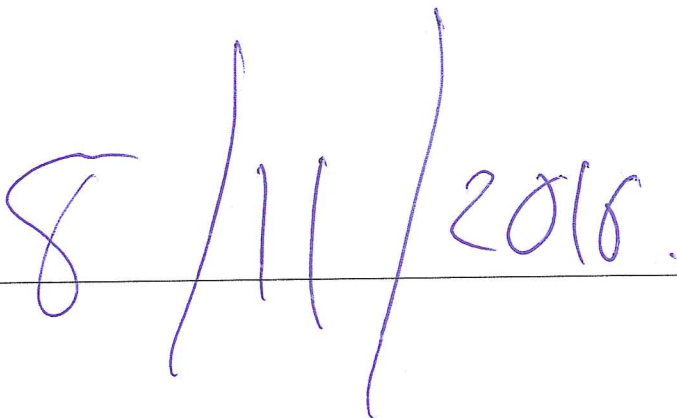
**From:** Trudy Chatting**Sent:** 06/10/2016 09:35**To:** Adam Hodgkins**Subject:** RE: plot G2

Hi Adam

The Invoices were posted yesterday so you should receive it this week.

Could you just e-mail me stating you would like to put up a greenhouse and the size of it. This will then go to the Property Meeting on the 8 November.

You will also receive a letter in the next few days inviting you to the Plotolders Meeting which is also on the 8 November.

Regards

Trudy

Trudy Chatting

Accounts Clerk & Mayor's Secretary

Liskeard Town Council

Tel: 01579 345407

Fax: 01579 324429

Email: accounts@liskeard.gov.uk

Office opening hours: Monday, Tuesday & Thursday 9.00am to 2.00pm

Wednesday & Friday: 9.00am to 1.00pm

Disclaimer: This email may contain privileged and/or confidential information. If you receive this in error, please notify the sender immediately and do not use, rely upon, copy, forward or disclose its content to any other party. Any views or opinions expressed are those of the author and do not necessarily represent those of the Town Council. It is the responsibility of the recipient to ensure that it is virus free before using it and no responsibility whatsoever is accepted by the Town Council for any loss or damage arising in any way from its use.

-----Original Message-----

From: "Adam Hodgkins" <adam.1966hodgkins@gmail.com>

Sent: Wednesday, 5 October, 2016 8:20pm

To: "Trudy Chatting" <accounts@liskeard.gov.uk>

Subject: plot G2

Hi Trudy

I have not had the invoice yet? just checking that the royal mail have not lost it :)

On another point is it possible to put a request in for greenhouse on the plot please.

Kind regards

Adam.

25 OCT 2018
7mawdin close
Liskeard
Cornwall
PL14 3DN
25.10.16

Tel 07885910336

Dear Town Council,

I am writing to ask permission to

erect a 3ft x 4ft Shed on my allment at Pengover.

my plot number is A3, my allment is 40ft x 40ft.

I would like to put it as shown in the diagram.

many thanks

Trevor Rashleigh

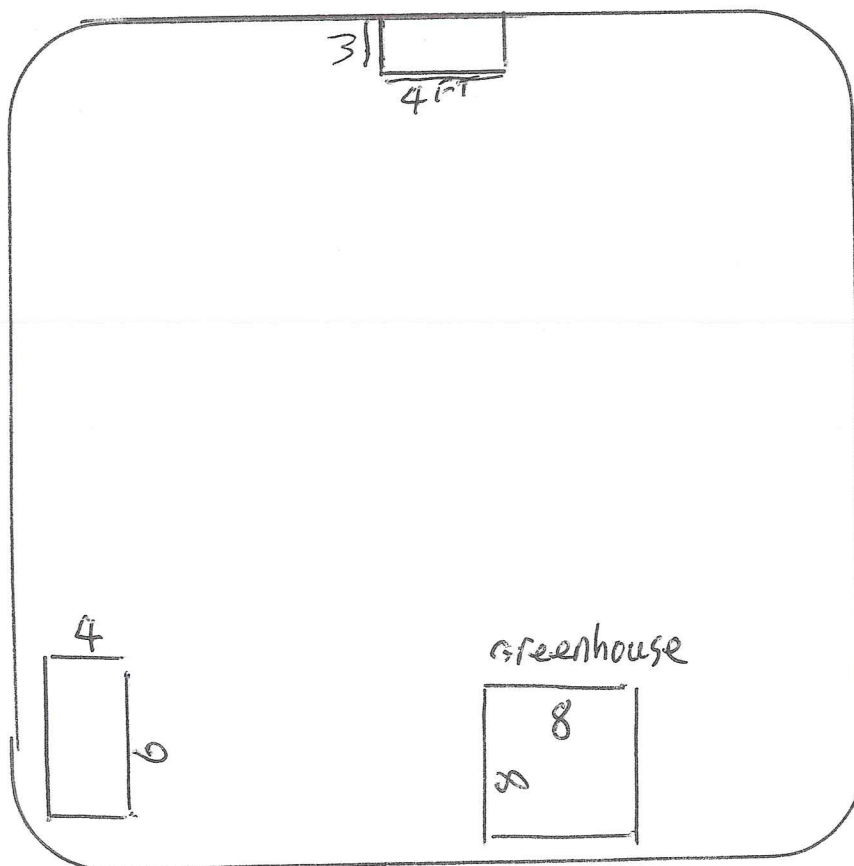

TOWN CLERK
Liskeard Town Council
West Street
LISKEARD
CORNWALL

26/10/2016

Dear Sir,

I am writing to you as suggested I do by your office staff, of giving you prior notice, on giving up my allotment plot ~~12~~ This is due to unforeseen circumstances with regards to a health problem. This will be approximately within the next five weeks. I am leaving Cornwall altogether.

M I

Mrs Byrne of plot ~~1~~ N has agreed to buy my greenhouse with my shed and she has said that she would like to swap over from her present plot and take over mine, this would be ideal as she would not have to move anything.

I have passed the message on to her, for her to also apply to you in writing to do this.

Thank You. R. Wakeford.

GIVING UP ALLOTMENT 15 NOVEMBER 16

MOVING 20 NOVEMBER 16.

10 Eastern Avenue
Liskeard
Cornwall
PL14 3TD

01579 349059
07871 197740

31st October 2016

Dear Liskeard Town Council

Re Pengover allotment – Account Byrne Plot M1

Following Raymond Wakeham's notice to leave plot L2, on 15th November 2016, I wish to transfer to the aforementioned plot to that effect please as suggested by the Pengover allotment association. I will be purchasing the greenhouse directly from Ray.

If possible, I would also like to retain my plot ownership of M1 for six months because I have overwintering veg/flowers in place.

I would also like to be considered to be able to retain the plot of M1 if at all possible for a longer period of time, if there is no suitable persons on the waiting list, based on my qualifications in RHS General Certificate in Horticulture and C&G Countryside management and experience as I wish to be able to enhance and develop a great local growing environment. I feel it is vitally important to maintain the plots to a high standard and teach my young daughter the beauty of horticulture.

As a divorced parent being able to support my family by growing fruit and veg really helps out, plus has a huge benefit on our mental health and wellbeing.

I hope this is possible, but I understand if this not.

I look forward to hearing from you

Yours kindly

Jan Byrne