



4 Precedent Images  
1 : 1000

Dark painted shipping containers with natural wood contrast to reflect the materials and colours intended for the Work Sheds and Market Canopy buildings



2 3D View 3

Internal view from entrance, looking towards work units and courtyard

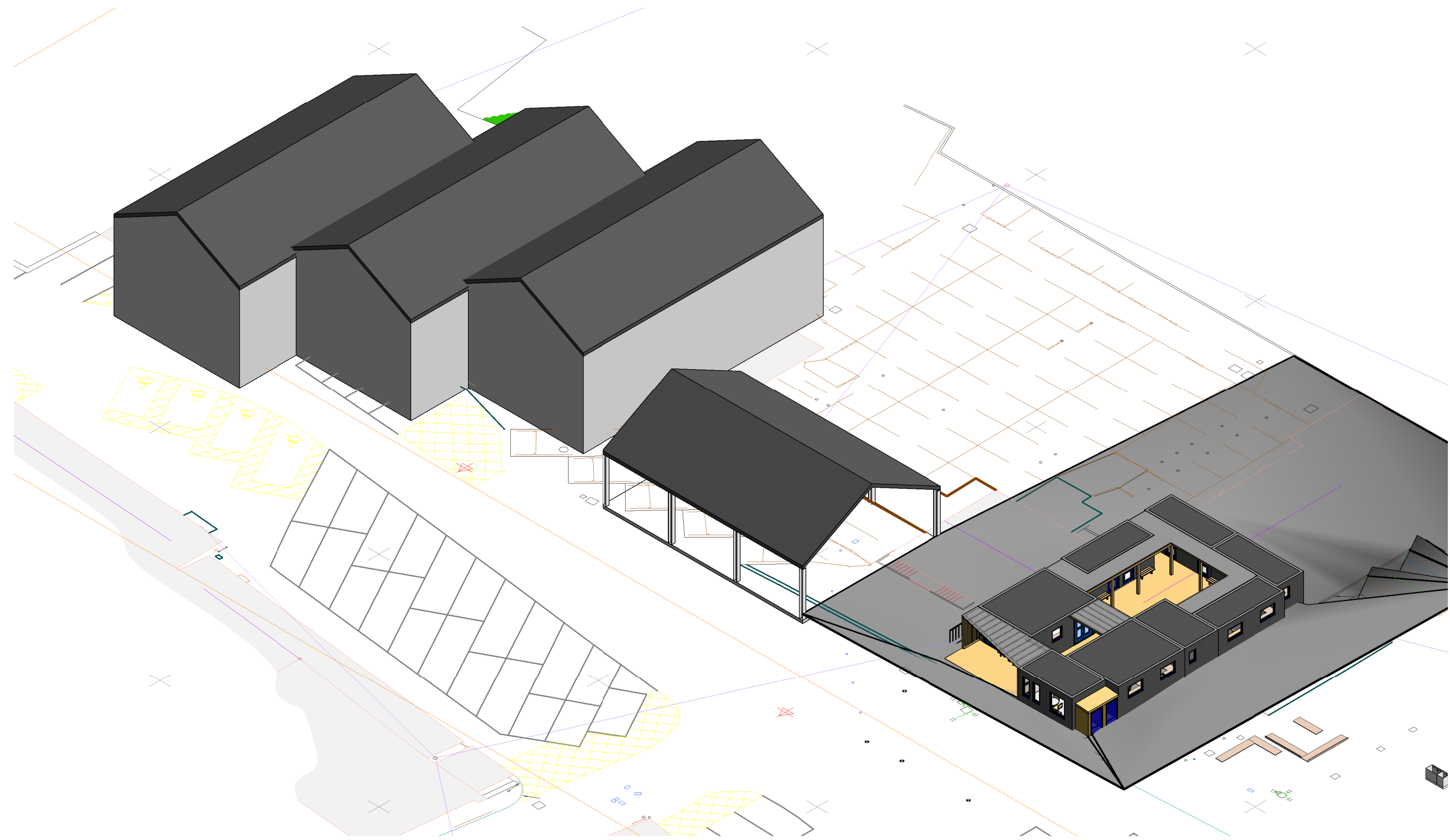

3 Proposed 3D Isometric

Preliminary Sketch Isometric view of work space units in context with Work Sheds and Market Canopy buildings.



1 3D View 1

Preliminary Sketch Ground level view of work space units with massing of Work Sheds and Market Canopy in background.

NOTES

- 1 THIS DRAWING IS THE COPYRIGHT OF THE ARCHITECT AND MAY NOT BE REPRODUCED WITHOUT LICENCE.
- 2 DO NOT SCALE OFF THIS DRAWING CONSTRUCTION PURPOSES.
- 3 ALL DIMENSIONS AND LEVELS ARE TO BE CHECKED ON SITE BY THE CONTRACTOR BEFORE COMMENCEMENT OF WORK AND ANY DISCREPANCIES REPORTED TO THE ARCHITECT.
- 4 NO RESPONSIBILITY CAN BE ACCEPTED FOR ERRORS ARISING ON SITE DUE TO UNAUTHORISED VARIATIONS FROM THE ARCHITECTS DRAWINGS.
- 5 DRAWINGS ISSUED ELECTRONICALLY MAY LOSE SOME DETAIL.

NOTES:

This drawings contains the following model files:

XXX-PBW-XX-XX-M3-A-0001-Name [S1] [P1]

AMENDMENTS

Rev. No	Revision Description	Rev. Date	Issued by
1	Post Design Workshop Issue	26.01.21	MW
2	Updated Design Issue	17.02.21	MW

PRELIMINARY DRAFT

POYNTON BRADBURY WYNTER COLE  
Architects Ltd  
ATLANTIC STUDIO, TRELYON AVENUE,  
ST. IVES, CORNWALL. TR26 2AD  
Tel. 01736 792000.  
E-Mail: architects@pbwc.co.uk  
www.pbwc.co.uk



Project Number: 3767

Project Name: Liskeard CLLD  
SE0032

Title  
DESIGN WORKSHOP 2 IMAGES

Project  
3767 - PBWC - XX - XX - DR - A - 6002

Purpose of Issue	Status	Revision
For Information	S1	P2

Scale  
1 : 1000@A1

Director In Charge	Project Architect	Off. Project No.
CS	MW	3767