

HIGHWAY SOAKAWAY
 Infiltration tanks to be constructed using Polystorm 40T Infiltration Units to the manufacturer's Standard Details.

Each crate is 1.0m long x 0.5m wide x 0.4m deep.

Phase One
 No. of attenuation units required= 750 units
 28 units long x 10 units wide x 3 units deep
 (26 metres) (5 metres) (1.2 metres)

INCOMING PIPE INVERT LEVEL= 35.866
 TOP OF SOAKAWAY LEVEL = 36.091
 BASE OF SOAKAWAY LEVEL= 34.891
 SOAKAWAY DESIGNED TO 5.38 x 10. INFILTRATION RATE.

Phase Two
 No. of attenuation units required= 357 units
 17 units long x 7 units wide x 3 units deep
 (17 metres) (3.5 metres) (1.2 metres)

INCOMING PIPE INVERT LEVEL= 34.475
 TOP OF SOAKAWAY LEVEL = 34.700
 BASE OF SOAKAWAY LEVEL= 33.500
 SOAKAWAY DESIGNED TO 5.38 x 10. INFILTRATION RATE.

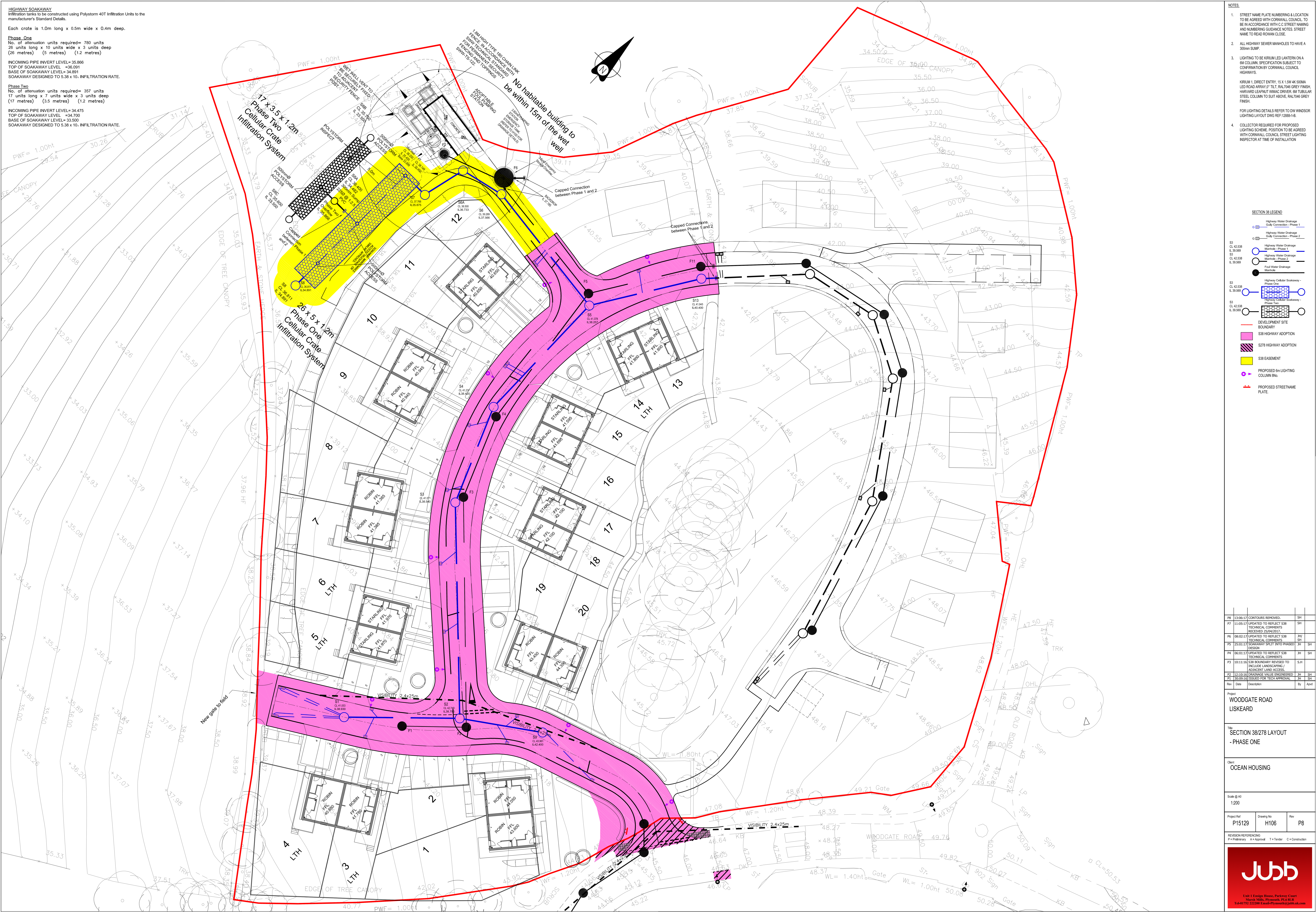

NOTES

- STREET NAME PLATE NUMBERING & LOCATION TO BE AGREED WITH CORNWALL COUNCIL. TO BE IN ACCORDANCE WITH C.C STREET NAMING AND NUMBERING GUIDANCE NOTES. STREET NAME TO READ 'KIRUM CLOSE'.
- ALL HIGHWAY SEWER MANHOLES TO HAVE A 300mm SUMP.
- LIGHTING TO BE KIRUM LED LANTERN ON A 60 COLUMN SPECIFICATION SUBJECT TO CONFIRMATION BY CORNWALL COUNCIL HIGHWAYS.
 KIRUM 1, DIRECT ENTRY, 15 X 1.5W 4K 500MA LED ROAD ARRAY (7' TILT), RAILING GREY FINISH, HARVARD EXPOSIT WING DRIVER, 60 TUBULAR STEEL COLUMN TO SUIT ABOVE, RAILING GREY FINISH.
 FOR LIGHTING DETAILS REFER TO DW WINDSOR LIGHTING LAYOUT DWG REF: 1288-16.
- COLLECTOR REQUIRED FOR PROPOSED LIGHTING SCHEME. POSITION TO BE AGREED WITH CORNWALL COUNCIL STREET LIGHTING INSPECTOR AT TIME OF INSTALLATION.

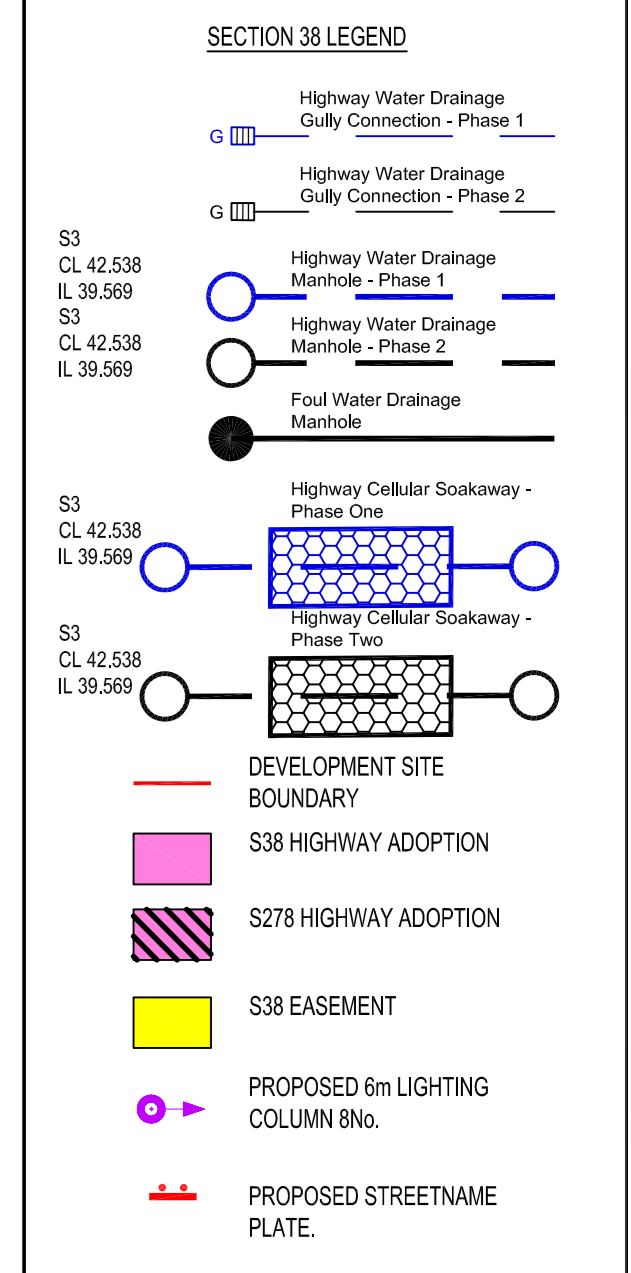

Rev	Date	Description	By	App'd
P8	13/06/17	CONTOURS REMOVED	SM	
P7	11/05/17	UPDATED TO REFLECT S38 TECHNICAL COMMENTS RECEIVED 20/04/17	SM	
P6	08/02/17	UPDATED TO REFLECT S38 TECHNICAL COMMENTS	JV	
P5	25/01/17	SOAKAWAY SPLIT INTO PHASES PER DESIGN	SM	
P4	06/01/17	UPDATED TO REFLECT S38 TECHNICAL COMMENTS	JM	
P3	10/11/16	S38 BOUNDARY REVISED TO INCLUDE LANDSCAPING ADJACENT LAND ACCESS	SM	
P2	12/10/16	FOUNDRARY WALLS ENGINEERED FOR ADJACENT LAND ACCESS	JM	
P1	10/09/16	ISSUED FOR TECH APPROVAL	SM	

Project: WOODGATE ROAD LISKEARD

Section: SECTION 38/278 LAYOUT - PHASE ONE

Client: OCEAN HOUSING

Scale: @ A4 1:200

Project Ref: P15129 | Drawing No: H106 | Rev: P8

REVISION REFERENCING: P=Preparation, A=Approval, T= Tender, C=Construction

Jubb
 Ltd 1 Esage House, Parkway Court
 Monk Mills, Plymouth, PL4 8JY
 Tel: 01752 232360 Email: Plymouth@jubb.co.uk